

Automatic Glass-Logistics-Line

- automatic and in-time supply of the glass panes necessary for glazing
- infeed of glass panes through one or several automatic transport conveyors
- several scanners for feeding-in and requesting of glass panes is possible or requesting via central computer
- reduction of glass damages as reloading of glass panes onto glass racks is no longer necessary
- simple handling of heavy glass panes
- the number of compartments is variable
- various extension steps are possible
- standard compartment sizes max. 2.7 m deep and 2.3 m high for pane sizes with a width of 2.5 m and a height of 2.2 m
- standard thicknesses of insulating glass panes of 24 to 56 mm (belt conveyor 50 mm wide)
- dimensional changes upon request
- integration in the existing production flow possible without difficulty through different logistics systems. (Upon consultation with Urban's technical department)
- total height of the unit 2.8 m

GLA Glas-Logistics-Line

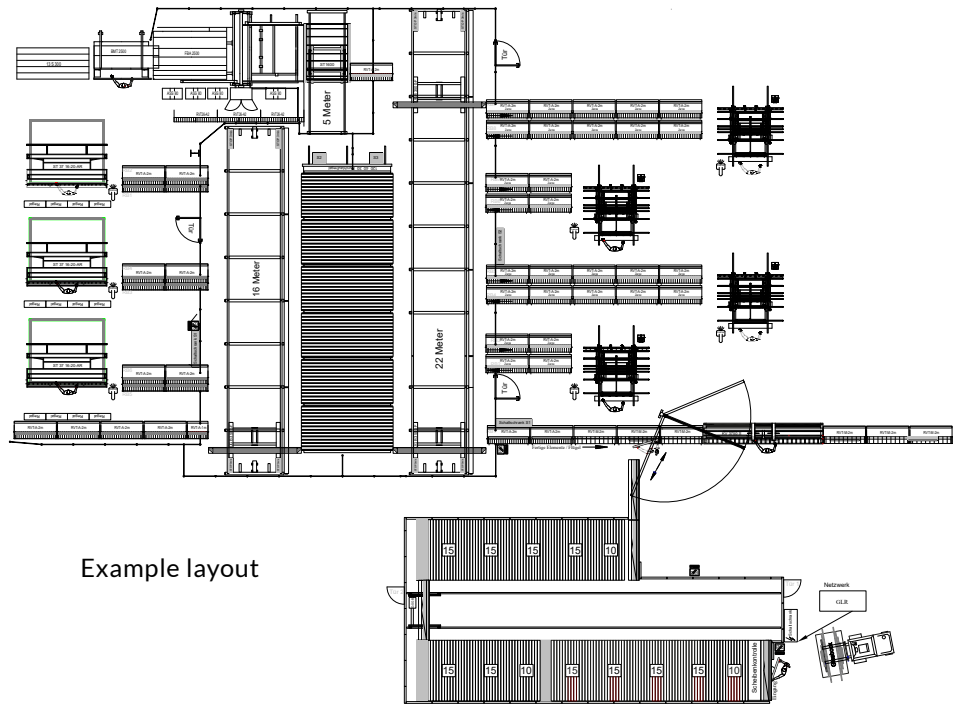

Example layout

Technical information

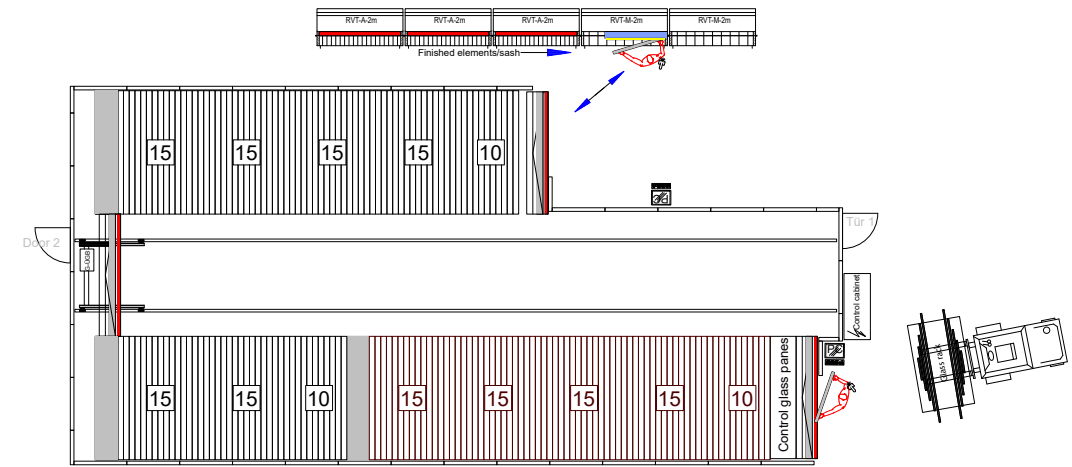

Sample plant with infeed and outfeed conveyor

⚡ 400 V
L1+L2+L3+N+PE
8,5 kW

🌀 7 bar

🕒 50 l / cycle



Technical data are valid for basic machine without options. Size according to layout.

Urban GmbH & Co. Maschinenbau KG

Dornierstraße 5
DE - 87700 Memmingen
Tel.: +49 (0) 8331 858 - 0
E-Mail: urban@u-r-b-a-n.com
www.u-r-b-a-n.com

① G-FA 2500

Automatic drive unit (Omega drive for a high dynamic and speed range up to 2.2 m/sec.).

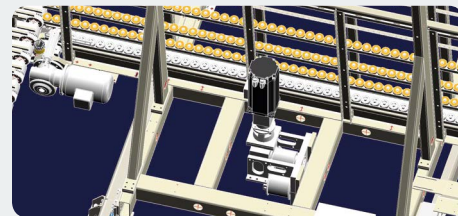

② G-Dock 2500

Docking unit with permanent lubrication installed for process-reliable operation.

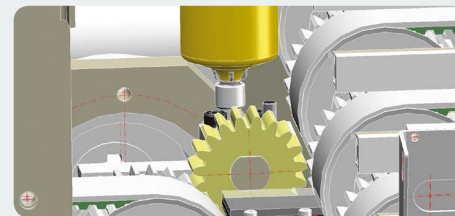

③ G-ÜGB 2500

Transfer conveyor with undercarriage for glass pane transport. Length 2.7 m; height 2.3 m for max. pane size 2.5 x 2.2 m.

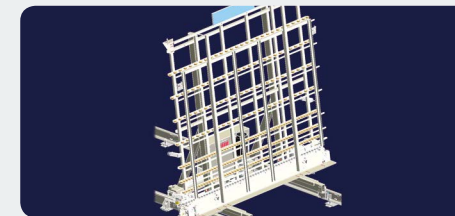

④ G-RVT-G-A

Basic module - outfeed conveyor for removal of glass panes. Linkage possible with several modules.



**Logistics
in a new
Dimension**

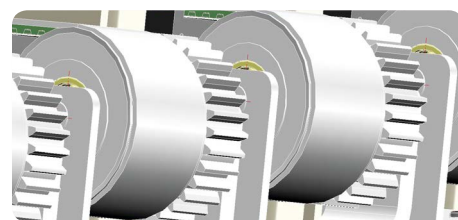
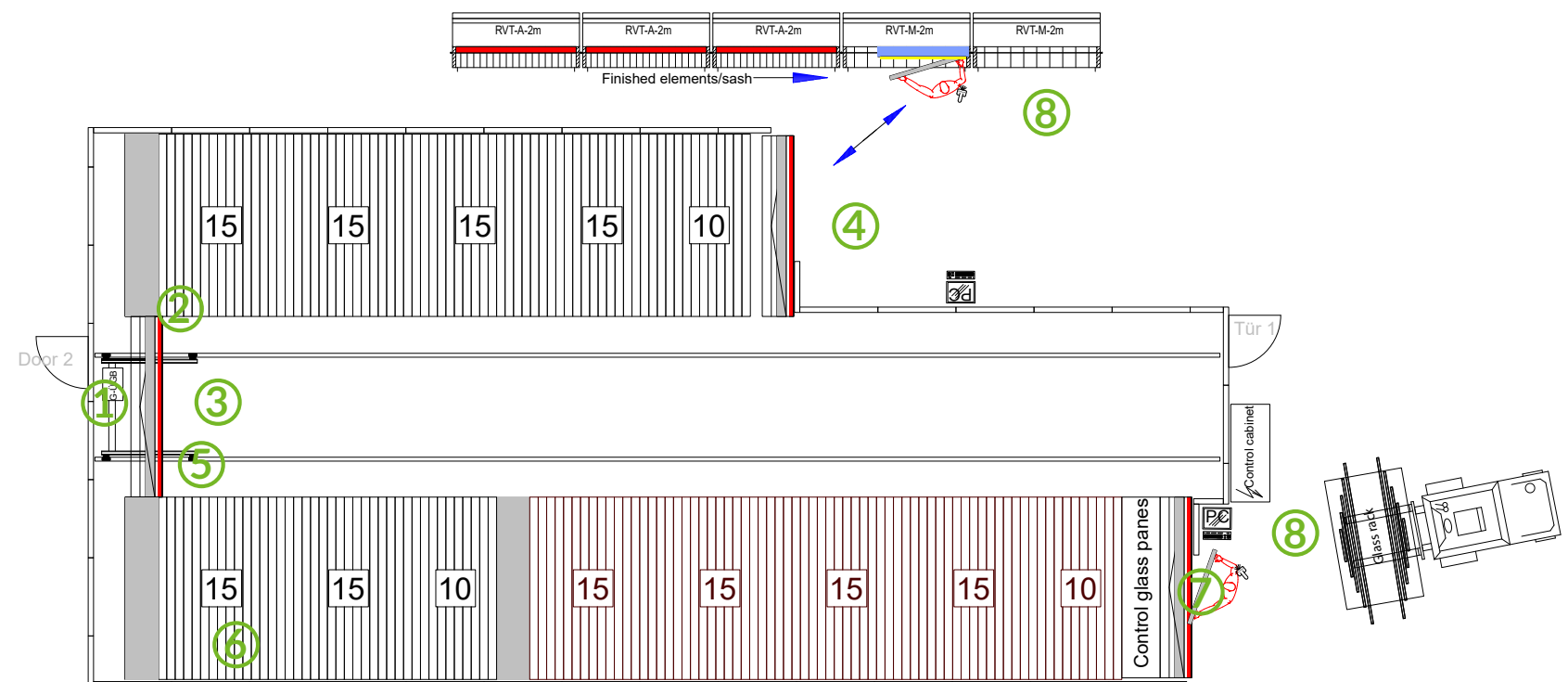

⑤ Detail

Positive-locking single compartment drive.



⑥ Glasflex - 25/22

Compartment blocks (5, 10 and 15 units) with vertical brushing device and 50 mm belt drive below. For pane thicknesses up to 56 mm, compartment size 2.7 m deep; 2.3 m high for max. pane size of 2.5 m x 2.2 m.

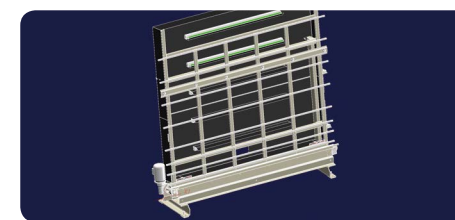

⑦ G-RVT-G-A

Basic module - automatic infeed conveyor with glass control through backlighting with fluorescent tubes (option G-RVT-GK). Length 2.7 m, height 2.3 m for max. pane size of 2.5 x 2.2 m.



⑧ SHF oder SHF-D

Scanner for identification of glass panes during infeed and of windows during outfeed.