

# AMS 6020

Screwing Unit



Product data sheet  
AMS 6020  
01/22 PR20052

## Our know-how - your advantage

The fully-automatic screwing unit AMS 6020 for steel reinforcement screwing in PVC window profiles offers proven Urban quality, optimal operating comfort, highest precision and an excellent price-performance ratio.

A clearly arranged PLC control and simple handling via display ensure comfortable operation of the unit. The screw advance unit of the AMS 6020 with integrated automatic screw feed and depth stop is the guarantee for efficiency.

Safe and reliable production through continuous and automatic monitoring of the screwing process. Another important feature of the AMS 6020 is its flexibility and adaptability to different profiles (even door frame profiles) allowing for stepless adjustment of all screwing positions and screwing distances. When placing an order, please state the requested throughput direction.

Capacity:

About 1600 profiles can be screwed in 8 hours' time (based on a profile rod length of about 1000mm with 4 screws each)

### Options

- profile identification between frame and sash (different screwing positions)
- identification of transom section for sashes and frames
- identification of locking case
- profile evacuation onto destacking table or roller conveyor
- hand-held scanner
- manual handling through 2-hand operation
- further screw lengths

### Technical information



550 / 590 kg



230 / 400 V  
L1-L2-L3-N-PE  
50 - 60 Hz  
1,5 kW



Supply line minimum nominal width 8 mm  
min. 7 bar



max. ~ 10 l/sec.

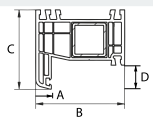

B = min. 40 mm  
max. 200 mm  
C = min. 35 mm  
max. 120 mm

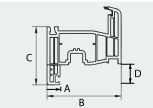

B = min. 40 mm  
max. 200 mm  
C = min. 35 mm  
max. 120 mm

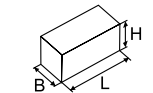

L = 5000 mm  
B = 1200 / 2150 mm  
H = 1800 mm

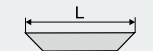

L = min. 300 mm

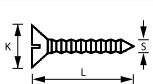

S = 3,5 - 4,8 mm  
K = 7 - 9 mm  
L = 14 - 35 mm  
U/min = 1600

Technical data are valid for basic machine without options. Size according to layout.

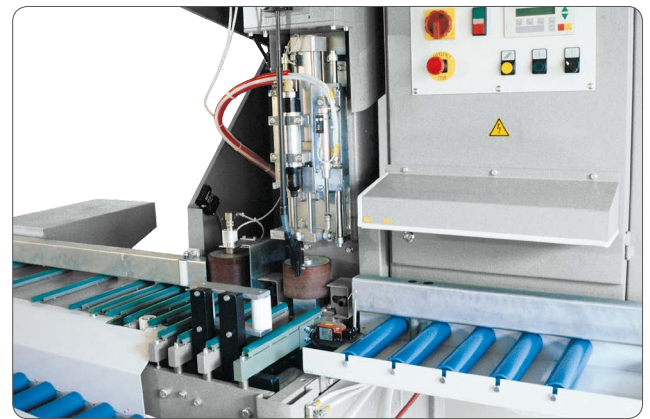

Screw advance unit

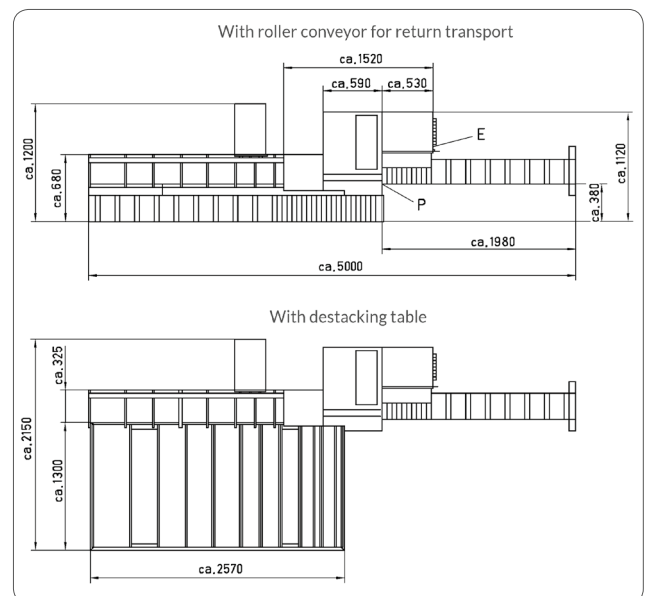

Urban GmbH & Co. Maschinenbau KG

Dornierstraße 5  
DE - 87700 Memmingen  
Tel.: +49 (0) 8331 858 - 0  
E-Mail: urban@u-r-b-a-n.com  
www.u-r-b-a-n.com

Subject to errors and modifications