

KFM 5000, KFM 6000-I/A

Contour machining



KFM 6000-I

Product data sheet
KFM 5000, KFM 6000-I/A
01/22 PR50092

Our know-how - your advantage

With the KFM versions, we developed for you very reasonable contour cutting machines for the machining of inner corners with radii and inclinations at PVC profiles welded in an angle of 90°.

With its productivity, quick functioning and versatility, the KFM optimally meets your production requirements.

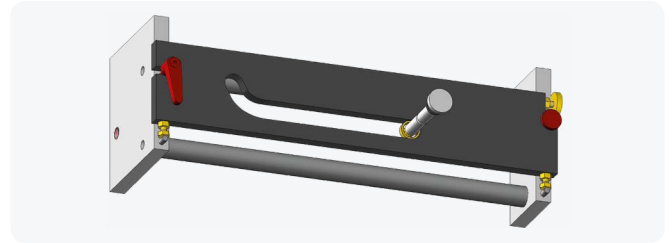
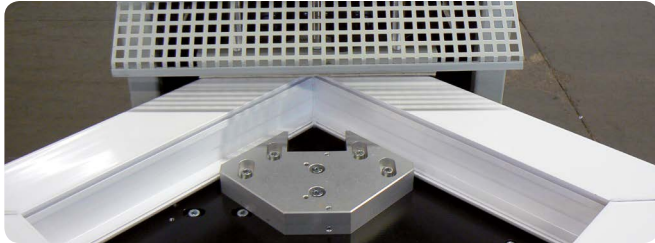

Exact machining

By the inner stop technique the profiles are optimally clamped and centered. This reduces the tolerances in the machining area to an absolute minimum.



Efficient and flexible

The exchangeable template for different contours ensures flexibility and the corresponding quick-change system saves a lot of precious production time (KFM 6000).

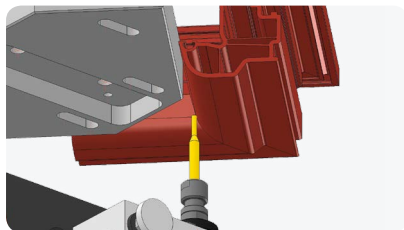

KFM 5000

Variant with shank-type cutter for the inner corner and parts of outer corner.

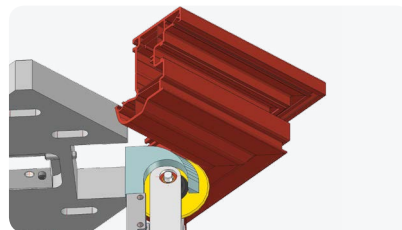

KFM 6000-I

Variant with disk cutter and tracer skid for inner corner and parts of visible surface (patented).

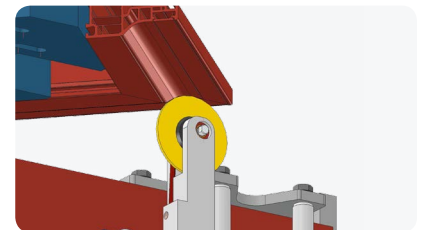

KFM 6000-A

Variant with disk cutter for the visible surface and parts of outer corner (different side milling cutter contours can be selected).

Technical information

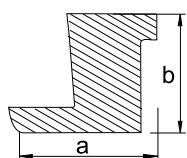

KFM 5000

a = 30 - 100 mm
b = 50 - 140 mm

KFM 6000-I

a = 30 - 130 mm
b = 50 - 140 mm

KFM 6000-A

a = 30 - 110 mm
b = 50 - 140 mm



130 kgs



KFM 5000 - 45.000 min⁻¹
KFM 6000 - 11.000 min⁻¹



7 bar

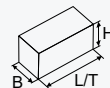

L/T = 900 mm
B = 520 mm
H = 1380 mm

Technical data are valid for basic machine without options. Size according to layout.

Urban GmbH & Co. Maschinenbau KG

Dornierstraße 5
DE - 87700 Memmingen
Tel.: +49 (0) 8331 858 - 0
E-Mail: urban@u-r-b-a-n.com
www.u-r-b-a-n.com

Subject to errors and modifications